

# DOWNINGTOWN HIGH SCHOOL EAST

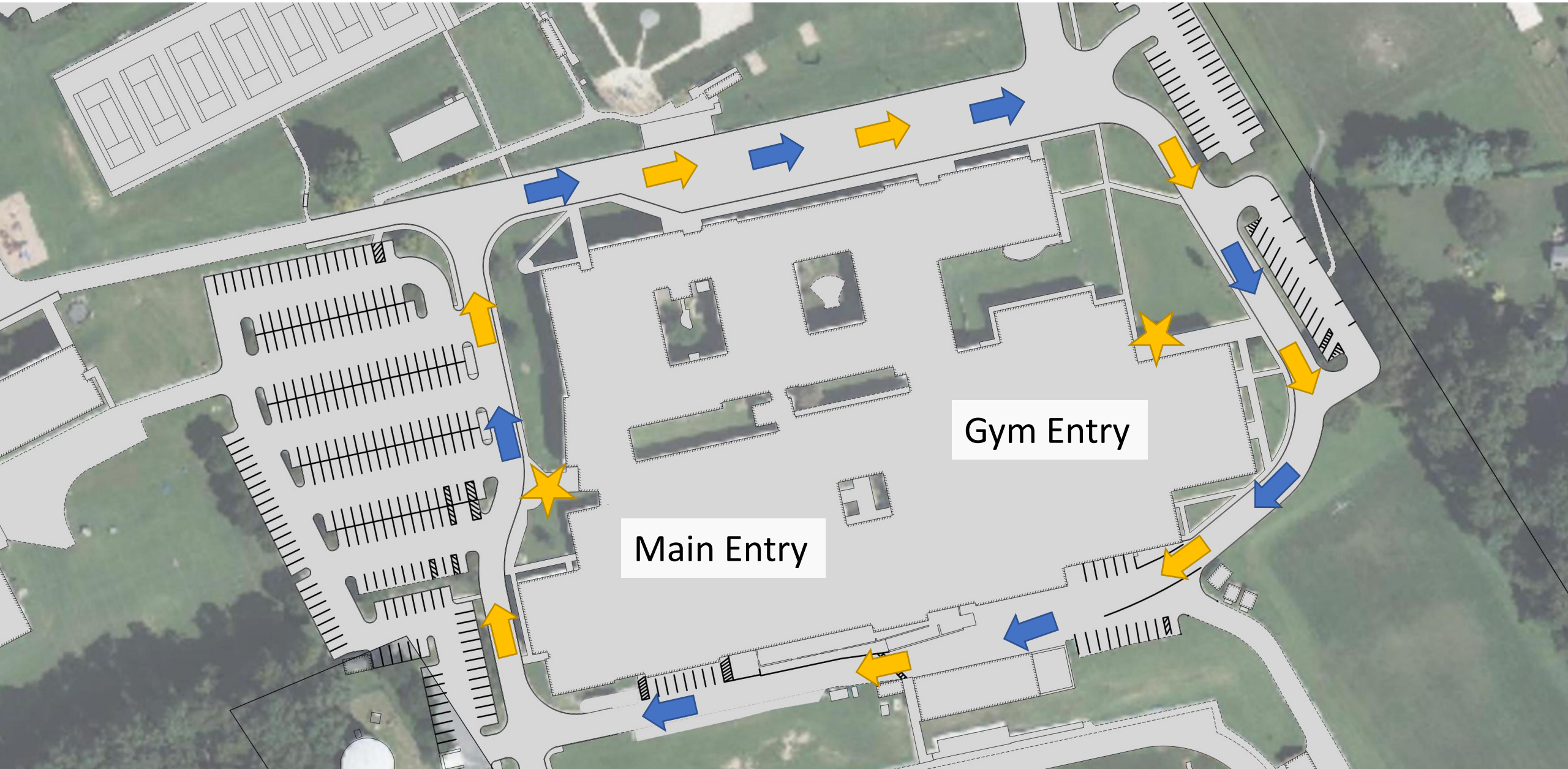

# DHS EAST – Existing Site Plan





# DHS EAST – Proposed Site Plan

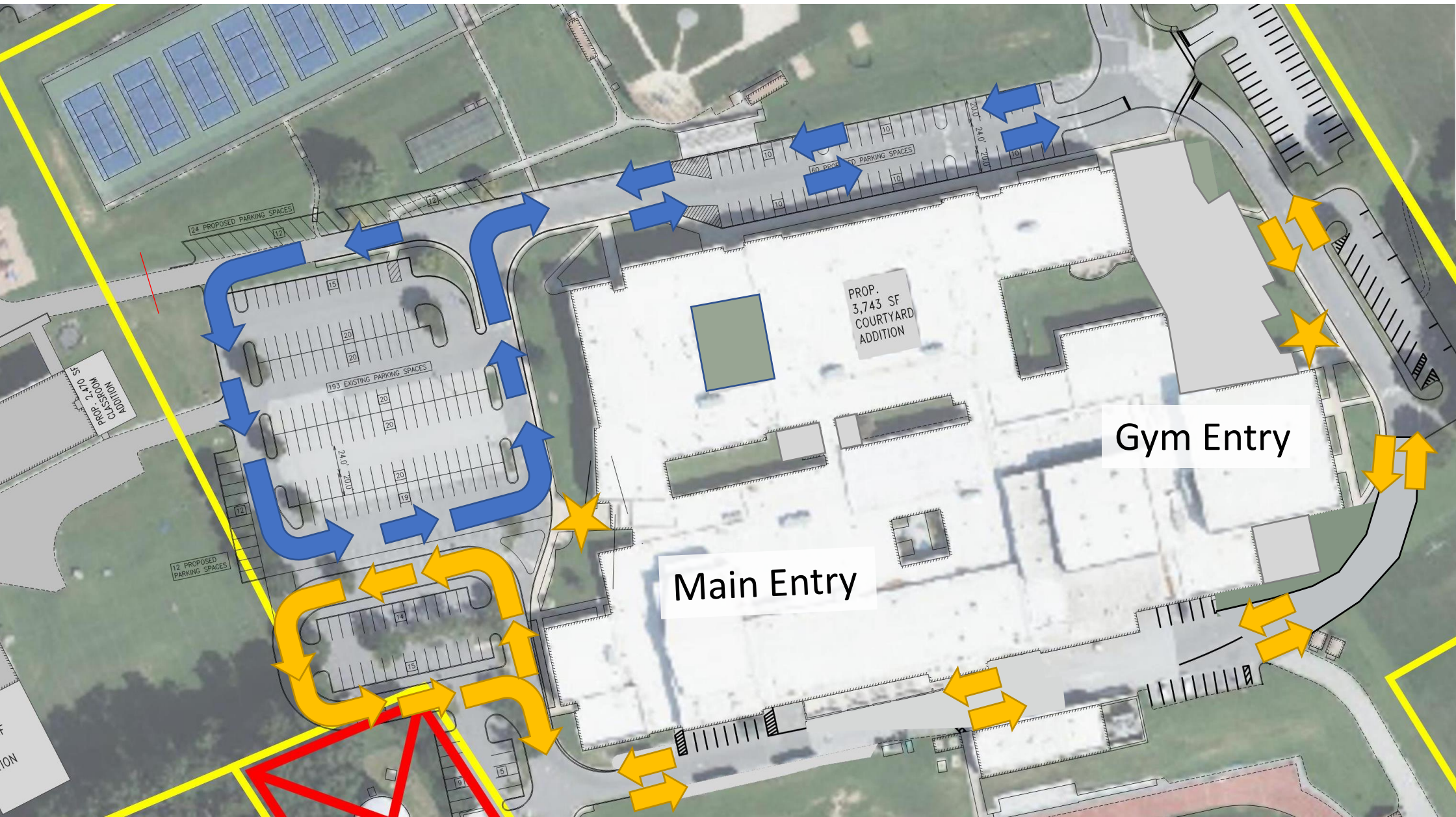

CIRCULATION IMPROVEMENTS (DHS)
GYM ADDITION (LES)
CLASSROOM ADDITION (LES)
TOTAL NEW IMPERVIOUS (SF.)
TOTAL NEW IMPERVIOUS (AC.)
TOTAL PROPOSED IMPERVIOUS COVERAGE (AC.)
PROPOSED IMPERVIOUS COVERAGE (%)

PARKING TABULATION:  
EXISTING PARKING SPACES IN AREAS OF  
PROPOSED PARKING SPACES IN AREAS OF



# DHS EAST – Existing First Floor Plan

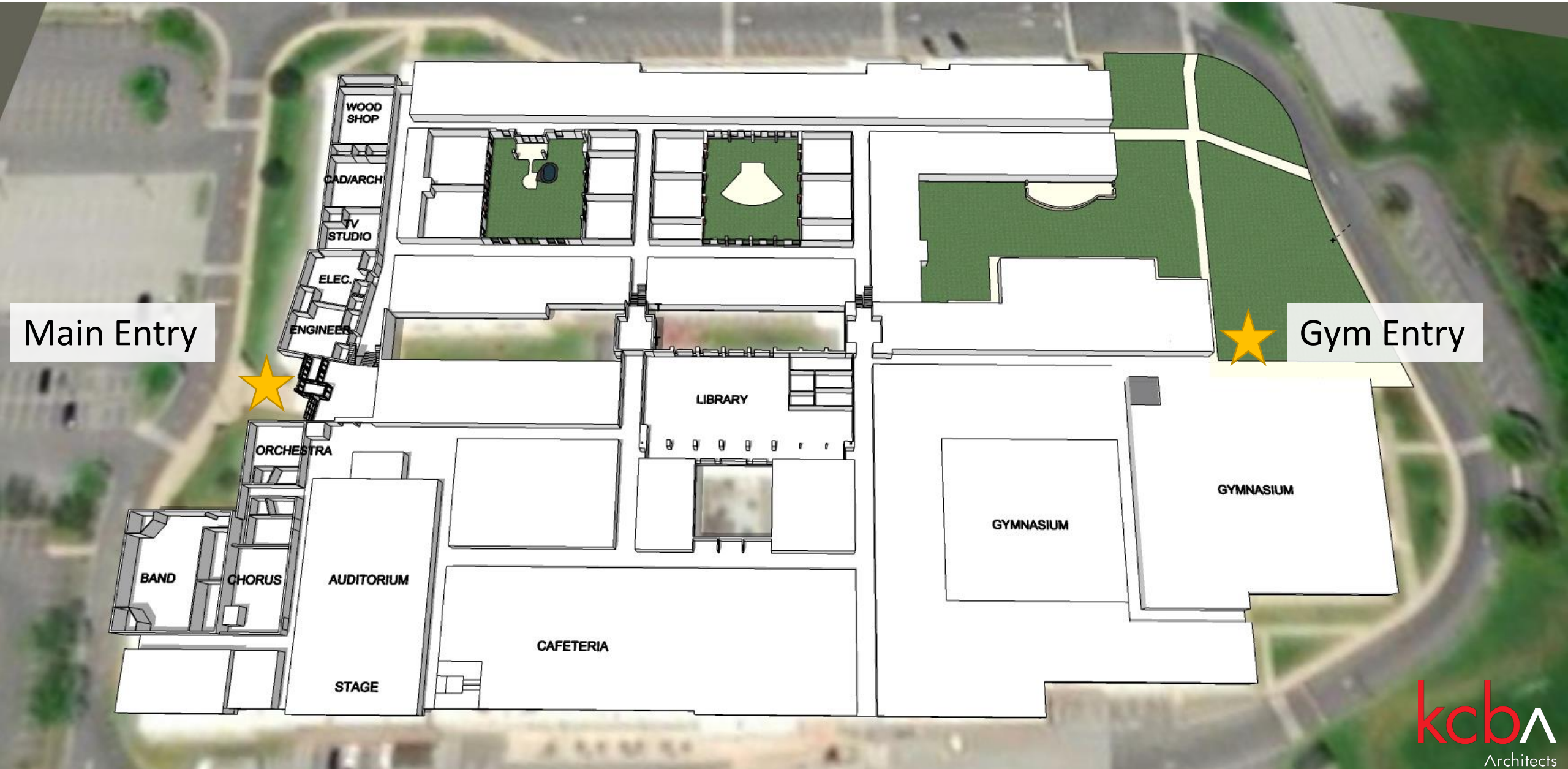

# DHS EAST – Proposed First Floor Plan





# DHS EAST – Existing Second Floor Plan



[illegible]



# DHS EAST – Existing First Floor Plan





# DHS EAST – Proposed First Floor Plan

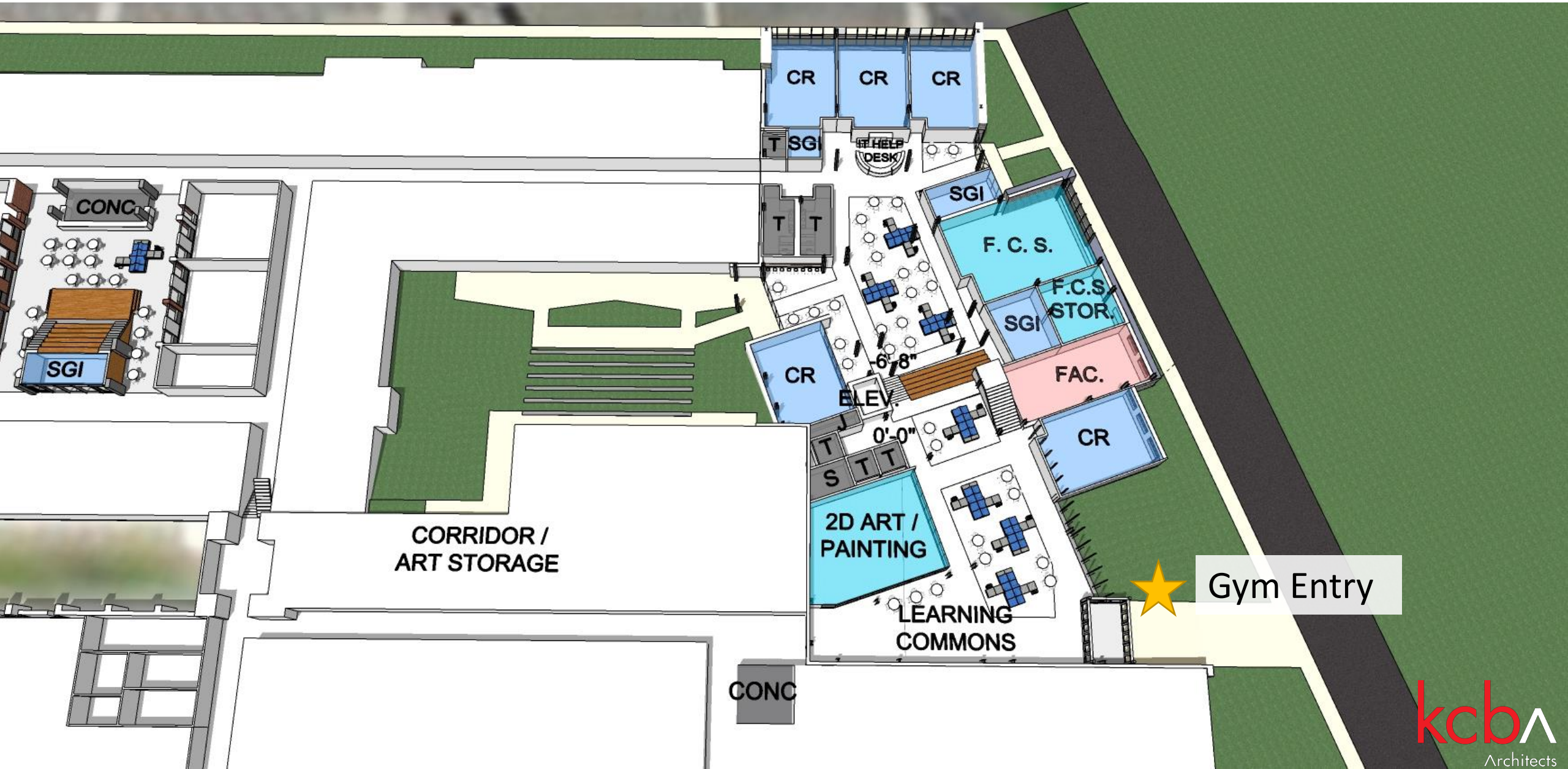



# DHS EAST – Proposed Second Floor Plan

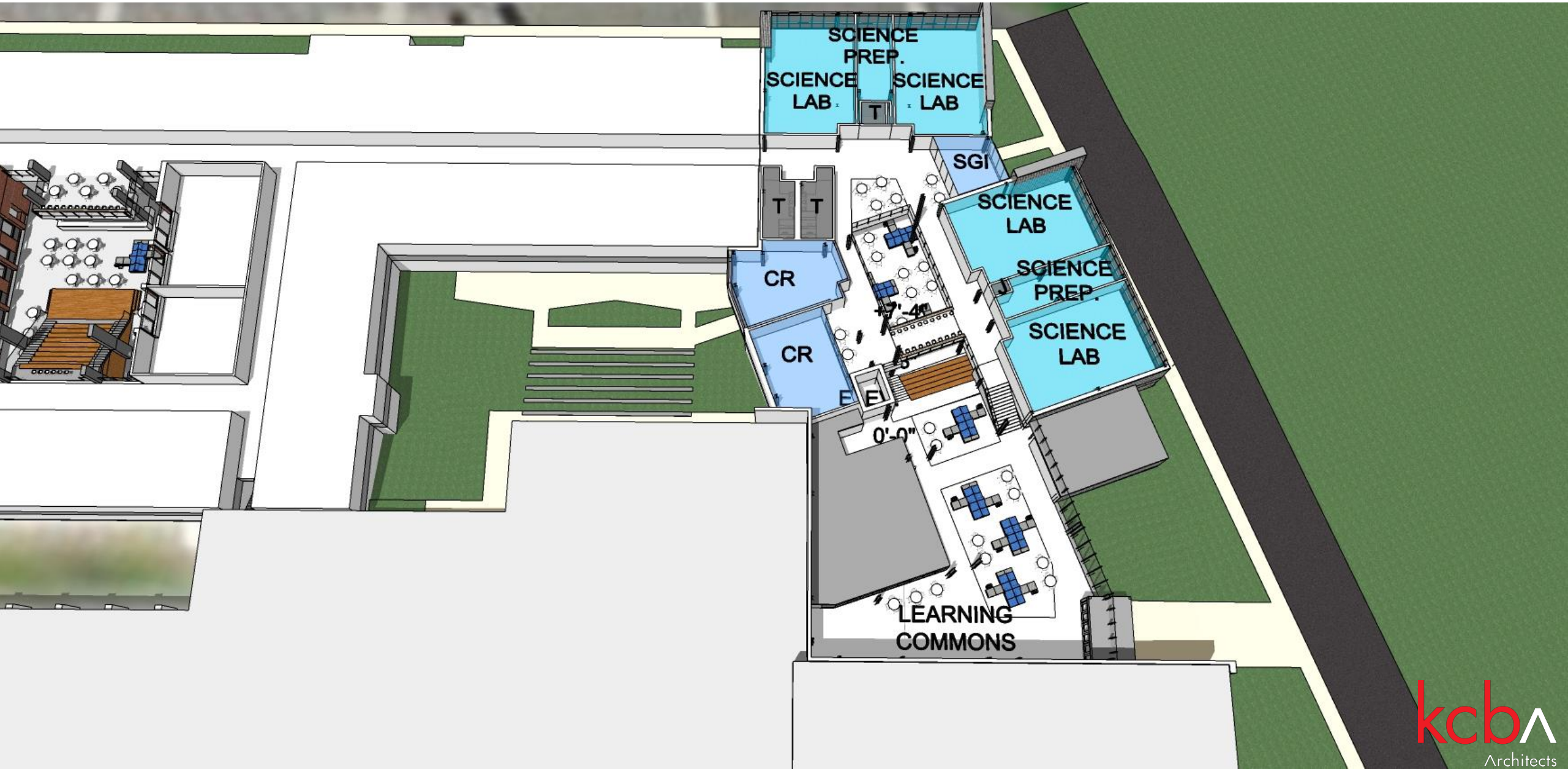



# DHS EAST – Schedule & Site Approval Process

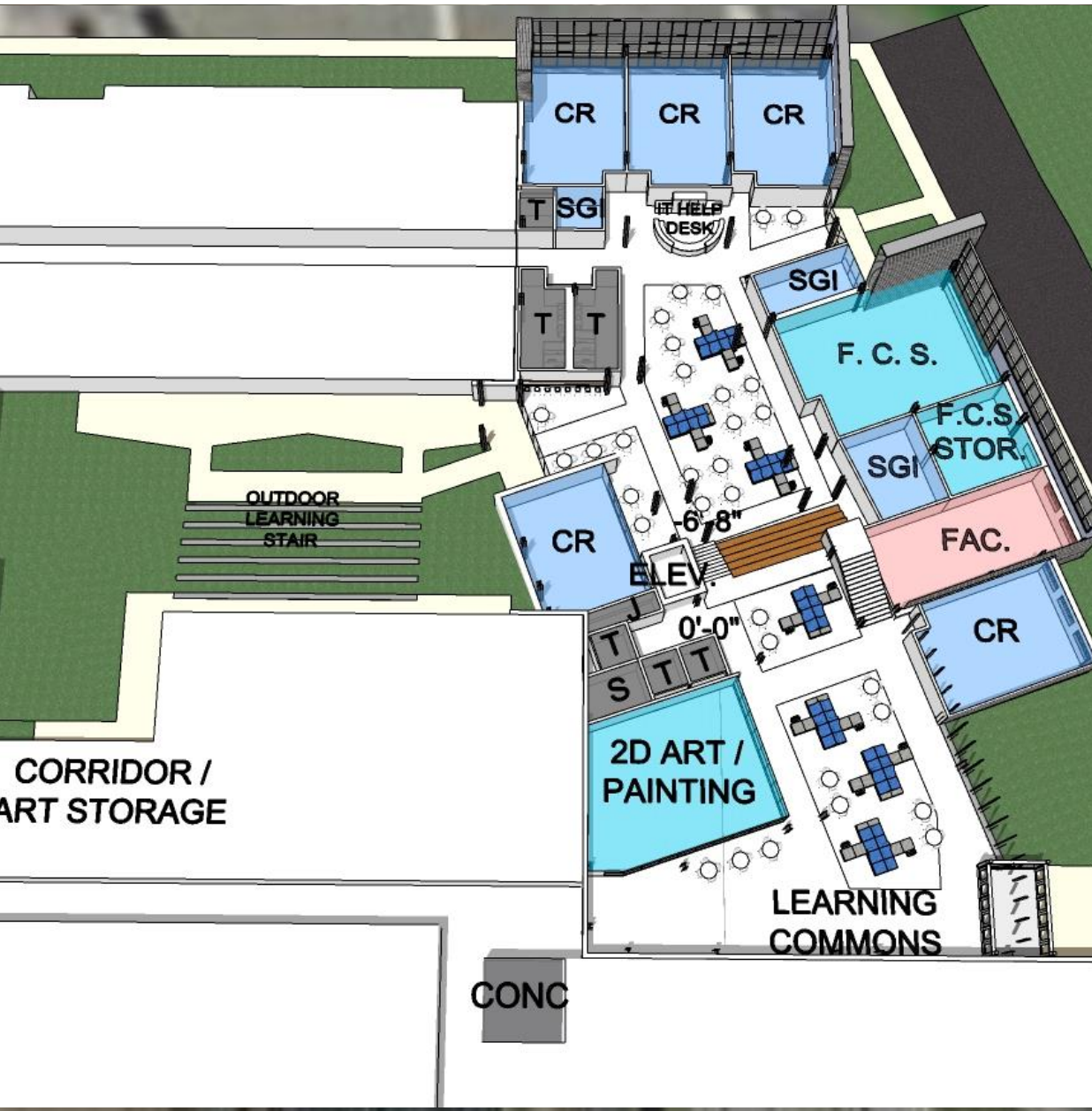

## Land Development

- Planning Commission
  - First Submission and Meeting
  - Revisions in Progress
  - Second Submission Nov 9<sup>th</sup>
  - Multiple Consultant Review
  - Second Meeting Dec 7<sup>th</sup>
- Supervisor Approval following Planning Commission Approval Recommendation
- Earthmoving Permit (NPDES) expected approval in June 2023

# DHS EAST – Project Schedule

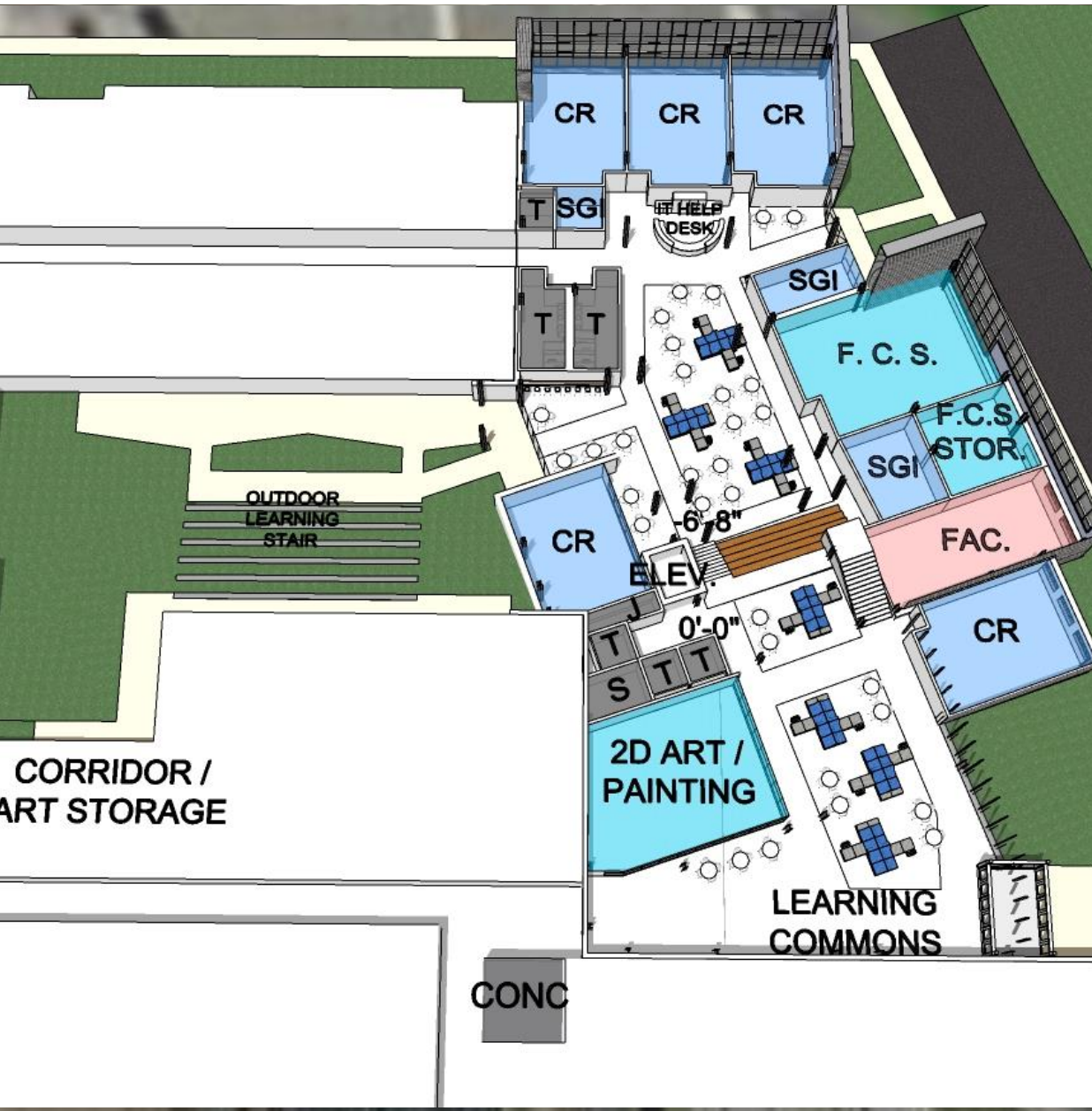

## Design & Documentation

February 2023 – Complete Construction Documents

February 28, 2023 – Out to Bid

March 28, 2023 – Open Bids

April 5, 2023 – Board Recommendation

**April 12, 2023 – Board Approves Bids**

## Target Construction

May 10, 2023 – Mobilization Begins

June 8, 2023 – Construction Begins

**August 2024 – Project Complete**



# DHS EAST – Total Project Budget

	Initial Estimate	Third Party Est.
<b>Construction Cost</b>	<b>\$23,773,981</b>	
5% Bidding Contingency	\$ 1,188,699	
<hr/>		
<b>Total Construction</b>	<b>\$24,962,680 <sup>(1)</sup></b>	
<i>Recommend 5.34% Escalation<sup>(2)</sup></i>		In Process - Available December 2022
10% Construction Contingency <sup>(3)</sup>	\$ 2,496,268	
15% Soft Costs <sup>(3)</sup>	\$ 3,744,402	
Furniture, Fixtures, & Equip. <sup>(3)</sup>	\$ 544,000	
<hr/>		
<b>Total Project Budget</b>	<b>\$31,747,350</b>	

<sup>(1)</sup> Includes Projects from 5-year Capital Plan

<sup>(2)</sup> Recommended by Third Party Estimator

<sup>(3)</sup> Budget Costs unchanged based on Construction Estimate

Current Estimate Excludes Operating Costs

# DHS EAST – Budget Adjustments

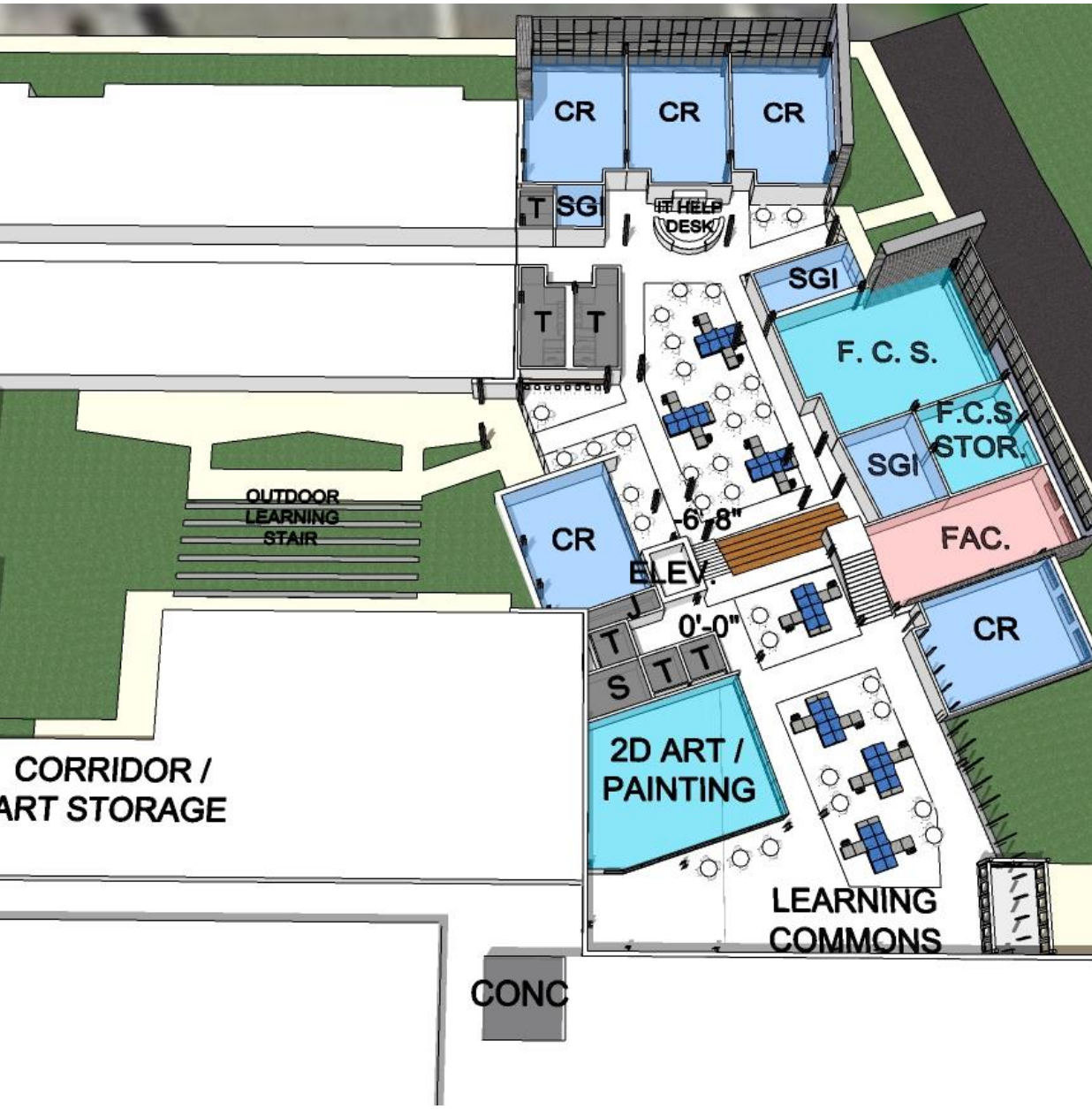

## Projected Budget Increase

- Auxiliary Gym at East
  - Sitework allows Construction
  - Less Expensive than at LES
  - Student Safety Consideration

## Alternates

- Board Adjustments Following Bids
  - Finishes
  - Deferred Construction
  - Alternate Manufacturers

## Direct Purchase by DASD

- Furnishings and Equipment
- Avoids Mark-Ups